

WAVE PERFORMANCE HMI

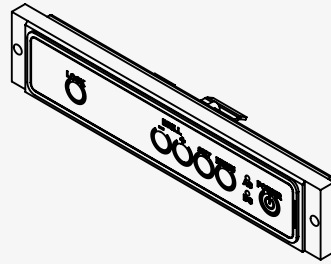

Note: Cable not shown

SUMMARY

ID	30047	NORTH INVENT PART NO	WE002 000 011
COMPANY NAME	North Invent Norway	NORTH INVENT TYPE NO	WE002-01.HMI.02-0011
VAT	987884002VAT	DRAWING REFERENCE	
ADDRESS	Sørhauggata 128		
	5527 Haugesund		
	NORWAY		

REVISION HISTORY

APPROVED	CHECKED	DRAWN	STATUS	DESCRIPTION
2021.12.20 OKJ	2021.12.20 OKJ	2019.02.20 RNO	Issued for Use	First Revision

2018022201

1/4

Specifications subject to changes without prior notice. The contents of this page are property of North Invent Norway AS. All rights herein are reserved to North Invent Norway AS. This document cannot be reproduced without the written permission of the company.

NORTH INVENT
Sørhauggata 128,
NO-5527 Haugesund, Norway
Phone: +47 48 84 02 00



WAVE PERFORMANCE HMI

TECHNICAL SPECIFICATIONS WE002 000 011

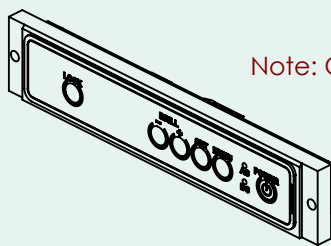
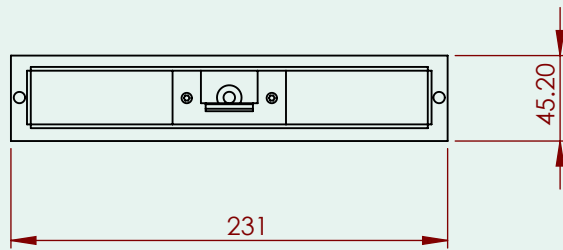
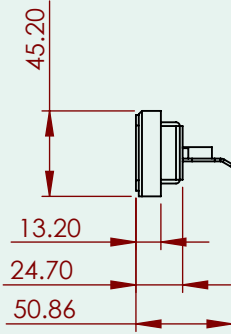

Note: Cable not shown

2x Screw for Panel mounting

WAVE PERFORMANCE HMI

TECHNICAL SPECIFICATIONS WE002 000 011

Front side installation
Cutout when using the adapter plate

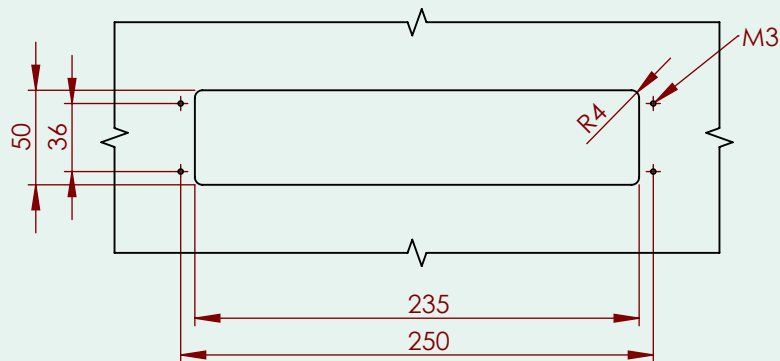

Back side installation
Powder coating must be taken into consideration
when preparing the cutout.

SECTION M-M

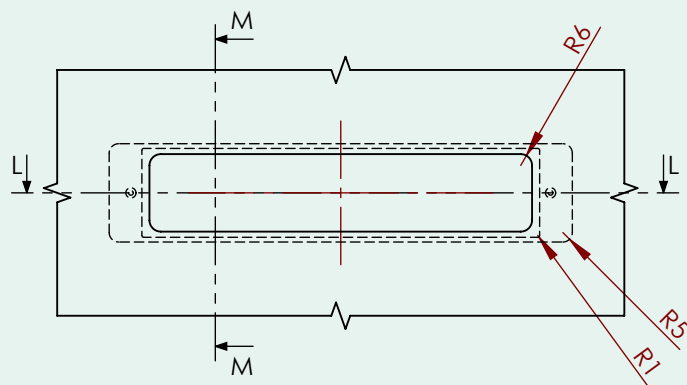
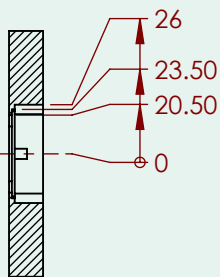

SECTION L-L

