

# WP 19" PANEL

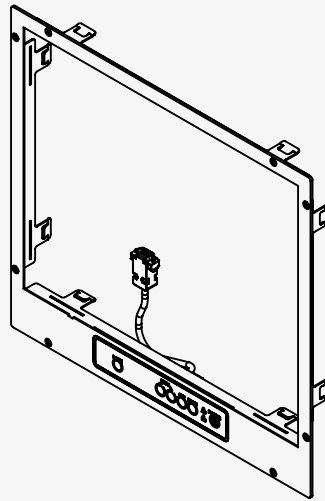

## SUMMARY

|                     |                     |                             |                                  |
|---------------------|---------------------|-----------------------------|----------------------------------|
| <b>ID</b>           | 130047              | <b>NORTH INVENT PART NO</b> | WE190 000 521 (Use for ordering) |
| <b>COMPANY NAME</b> | North Invent Norway | <b>NORTH INVENT TYPE NO</b> | WE190-01.PAN.02-Z521             |
| <b>VAT</b>          | 987884002VAT        | <b>DRAWING REFERENCE</b>    | WE190 000 212 DRW                |
| <b>ADDRESS</b>      | Sørhauggata 128     |                             |                                  |
|                     | 5527 Haugesund      |                             |                                  |
|                     | NORWAY              |                             |                                  |

## REVISION HISTORY

| APPROVED          | CHECKED           | DRAWN             | STATUS            | DESCRIPTION    |
|-------------------|-------------------|-------------------|-------------------|----------------|
| 2021.12.20<br>OKJ | 2021.12.20<br>OKJ | 2019.02.20<br>RNO | Issued for<br>Use | First Revision |
|                   |                   |                   |                   |                |
|                   |                   |                   |                   |                |
|                   |                   |                   |                   |                |
|                   |                   |                   |                   |                |
|                   |                   |                   |                   |                |

# WP 19" PANEL

The Wave II Monitors are a series of well-designed, rugged LED displays with full glass front and PCAP multitouch option.

The minimized outer measurements and modular design offer unprecedented configuration and mounting flexibility. Our unique hinge design ensures that table-top or ceiling mounting is equally easy and visually appealing as flush mounting the glass front into a cut-out.

All our monitors are provided with either AC, DC or AC/DC Multipower, whereas our proprietary controllerboard offer extended functionality and connectivity options.

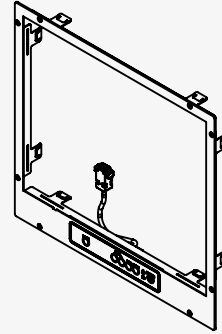

## TECHNICAL SPECIFICATIONS

### WE190 000 521

### MATCHING STANDARDS

IEC 60945, IACS E10, RoHS, REACH

|                                 |   |
|---------------------------------|---|
| OVERALL DIMENSIONS              | 448 (W) x 415 (H) x 44 (D) mm                                   |
| NET / GROSS WEIGHT              | 1.7 / 2.7 kg  |
| COLOUR                          | RAL 9005 Fine Structure   |
| MATERIAL                        | Carbon Steel  |
| MOUNTING CONCEPT                | Click On  |
| MATCHING ACCESSORIES            | Wave PERFORMANCE HMI Unit for Panel Mount                       |
| OPTIONAL                        | Customized size and mounting holes to adapt to existing cutouts |
| OPERATING / STORAGE TEMPERATURE | -15/+70° C, -15/+70° C (+5/+158° F, +5/+158° F)                 |

# WP 19" PANEL

## TECHNICAL SPECIFICATIONS WE190 000 521

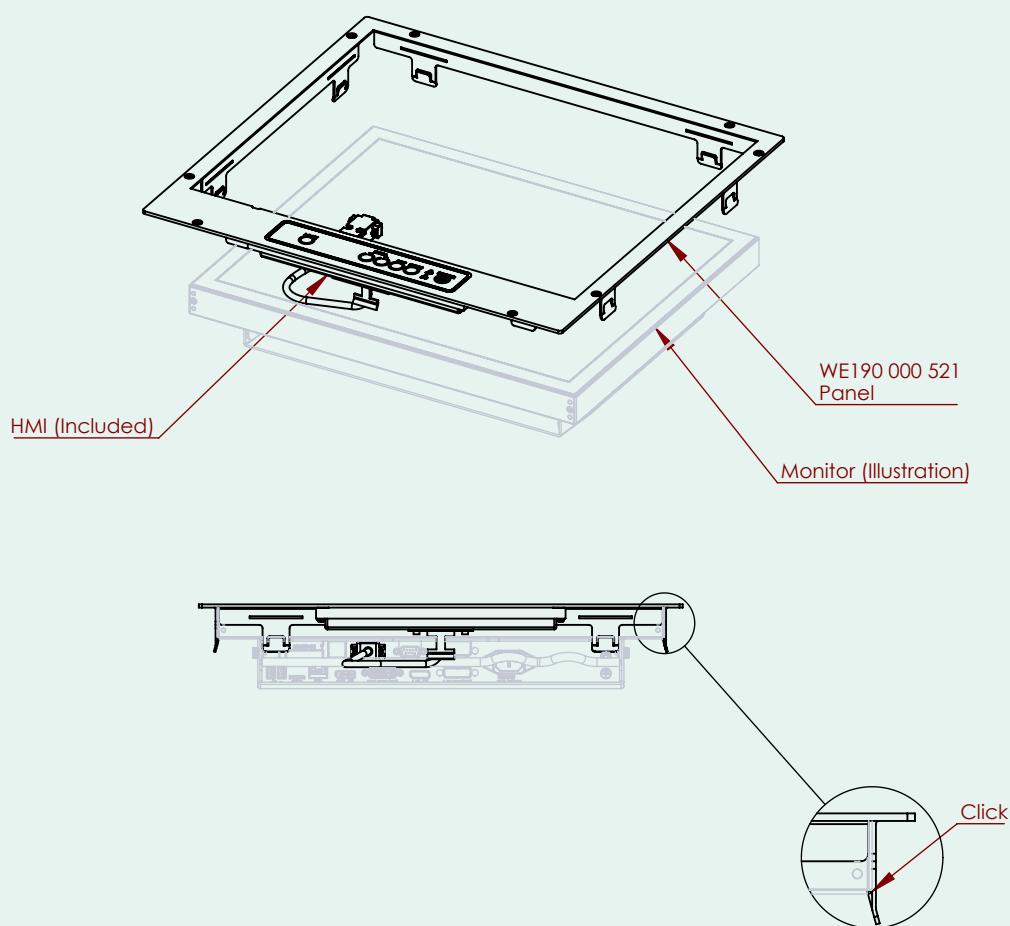

# WP 19" PANEL

## TECHNICAL SPECIFICATIONS WE190 000 521

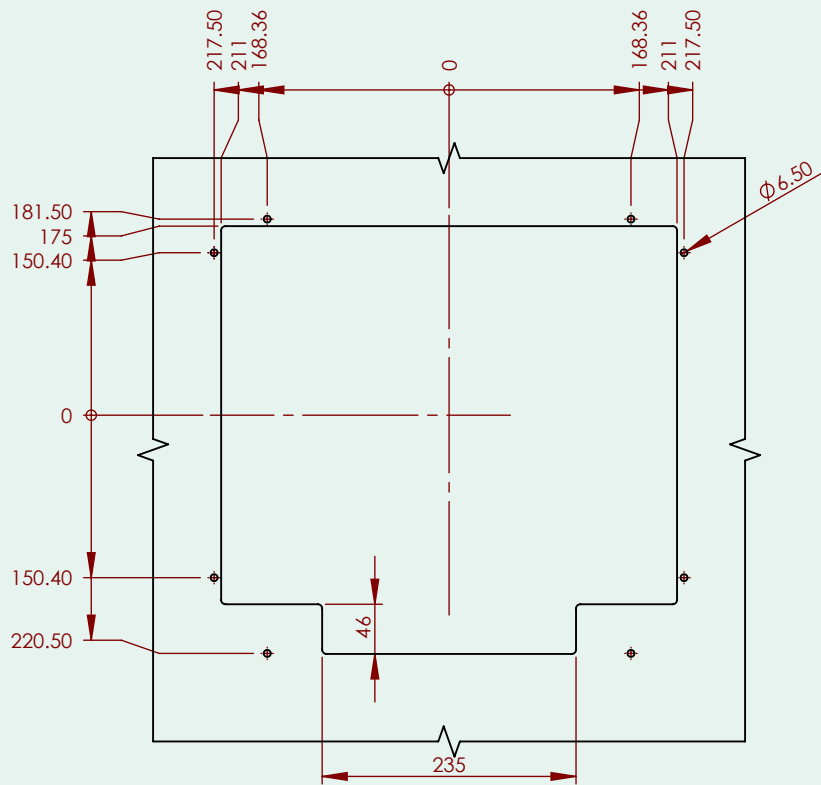

CUTOUT

# WP 19" PANEL

## TECHNICAL SPECIFICATIONS WE190 000 521

