

WAVE PERFORMANCE

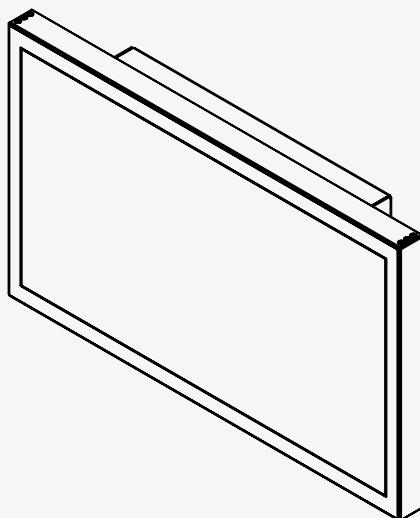

SUMMARY

| | | | |
|---------------------|---|--|------------------------------|
| ID | 30047 | CPU OPTION: | NORTH INVENT PART NO: |
| COMPANY NAME | North Invent Norway | Celeron 4305UE @ 2.2 GHz | WE215 000 445 |
| VAT | 987884002VAT | i3-8145UE @ 2.2 GHz / 3.9 GHz | WE215 000 446 |
| ADDRESS | Sørhauggata 128 5527 Haugesund NORWAY | i5-8365UE @ 1.6 GHz / 4.1 GHz | WE215 000 447 |
| | | i7-8665UE @ 1.7 GHz / 4.4 GHz | WE215 000 448 |
| | | NB! To order optional PSU versions and / or I/Os listed on the next page, please ask your North Invent representative for the correct P/N. | |

REVISION HISTORY

| APPROVED | CHECKED | DRAWN | STATUS | DESCRIPTION |
|-------------------|-------------------|-------------------|----------------------------------|----------------|
| 2020.01.29 OKJ | 2020.01.29 OKJ | 2020.06.12 RNO | Issued for Customer Review | First Revision |
| | | | | |
| | | | | |
| | | | | |
| | | | | |

2018022201

1/4

Specifications subject to changes without prior notice. The contents of this page are property of North Invent Norway AS. All rights herein are reserved to North Invent Norway AS. This document cannot be reproduced without the written permission of the company.

NORTH INVENT
Sørhauggata 128,
NO-5527 Haugesund, Norway
Phone: +47 48 84 02 00



WAVE PERFORMANCE

The Wave PERFORMANCE Box is a state-of-the-art computer concept, derived from the interchangeable Electronics Unit of the already type approved Wave II monitors.

In addition to being a stand-alone box computer, the PERFORMANCE Box can be added on the back of a standard Wave II monitor to make up a Panel- PC (PPC); constituting the Wave PERFORMANCE Monitor. Extensive versatility allows for tailoring your optimal connections, SSDs, Memory and special features.

Designed for 10 years of manufacturing, the Wave PERFORMANCE Monitors are boasting powerful 8th Generation Intel® Core™ Processors. All Wave PERFORMANCE Boxes will remain fanless with low power consumption.

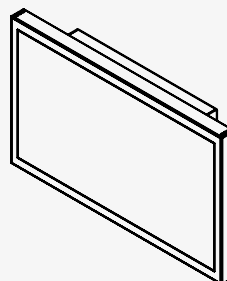

TECHNICAL SPECIFICATIONS Wave PERFORMANCE 21.5" NON-TOUCH

MATCHING STANDARDS

IEC 60945, IEC 61174 (ECDIS), IEC 62.288 (Navigation), IEC 62.388 (Radar), IACS E10, EMC Directive-2014/30/EU, RoHS, REACH
Compliant to a selection of MIL standards

| | |
|---------------------------------|---|
| DISPLAY SIZE | 21,5" - 546.1 mm, Active area 476.64 (W) X 268.11 (H) mm |
| OVERALL DIMENSIONS | 513.6 (W) x 310.6 (H) x 78 (D) mm |
| NET / GROSS WEIGHT | 7.0 / 10.1 kg |
| RESOLUTION | Max 1920 x 1080 pixels (Full HD) |
| RESPONSE TIME | 16 ms |
| CONTRAST RATIO | 5000:1 (typ) |
| CPU | Intel® Celeron 4305UE, Core i3-8145UE, i5-8365UE, i7-8665UE |
| LIGHT INTENSITY | 300 cd/m2 (typ) |
| GRAPHICS | Intel® UHD Graphics 620 |
| VIEWING ANGLE | ±89° |
| SSD | 3 x M2 slot + SATA, configurable size 120 GB-2TB. Std configuration: 120 GB |
| SUPPLY VOLTAGE | 18-36 VDC (90-264 VAC (IEC Inlet) or AC / DC Multipower optional). |
| POWER CONSUMPTION | Approx. 46W |
| RAM | DDR4 2400, configurable size. Standard configuration: 8 GB |
| ENCLOSURE PROTECTION | IP 67 from front given correct mounting and sealing. |
| GLASS TYPE | 3mm Tempered, Anti Reflective Conturan® |
| INPUT/ CONTROL INPUT | 2 x 10/100/1000 Ethernet (4 x 10/100/1000 optional), 2 x Display Port , x USB 3.1 2 x USB 2.0, 2 x RS232/RS485/422 + 2 x RS232 (D-SUB), Line in + Line out (mini Jack), HMI (15pD-Sub) |
| OPERATING / STORAGE TEMPERATURE | -15/+70° C, -15/+70° C (+5/+158° F, +5/+158° F) |
| BACKLIGHT LIFE | Typ 50.000 Hours |
| DIMMING RANGE | 0-100% |
| OS SUPPORTED | Linux and Windows |
| TOUCH | NO |
| COMPASS SAFE DISTANCES | Standard Compass 190 cm, Steering Compass 120 cm |

2018101001

2/4

Specifications subject to changes without prior notice. The contents of this page are property of North Invent Norway AS. All rights herein are reserved to North Invent Norway AS. This document cannot be reproduced without the written permission of the company.

NORTH INVENT
Sørhauggata 128,
NO-5527 Haugesund, Norway
Phone: +47 48 84 02 00



WAVE PERFORMANCE

TECHNICAL SPECIFICATIONS Wave PERFORMANCE 21.5" NON-TOUCH

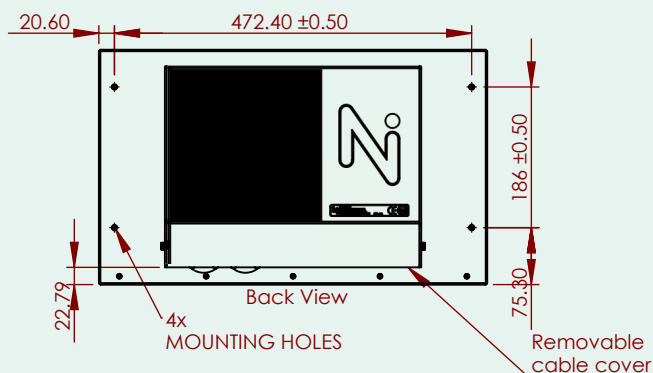
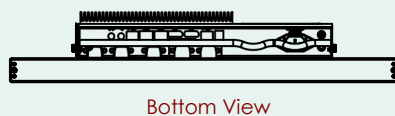
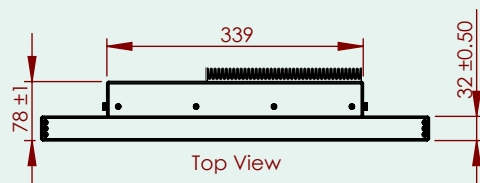
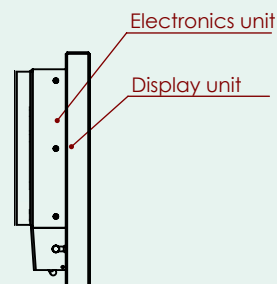
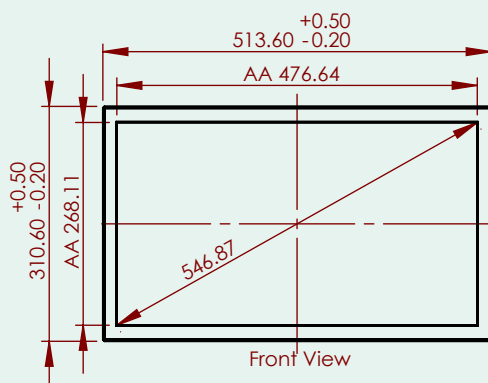

WAVE PERFORMANCE

TECHNICAL SPECIFICATIONS Wave PERFORMANCE 21.5" NON-TOUCH

Included in Part 1 of 1

| ITEM NO. | PART NUMBER | DESCRIPTION | QTY. |
|----------|-------------|-------------|------|
| | | | |
| | | | |

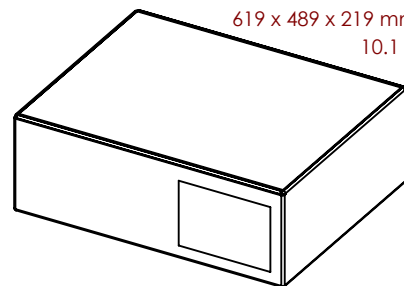
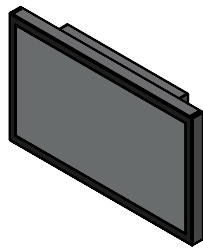

Part 1 of 1
619 x 489 x 219 mm
10.1 kg