

# WAVE II 32" MONITOR

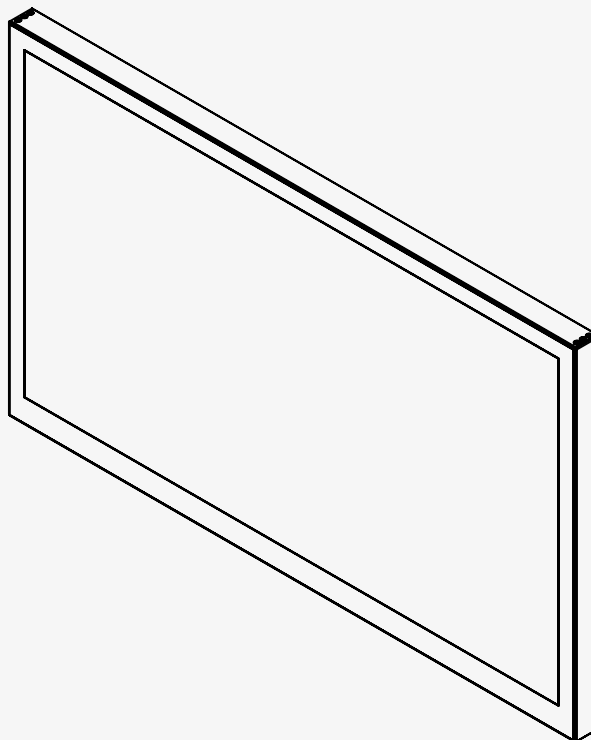

## SUMMARY

<b>ID</b>	30047	<b>NORTH INVENT PART NO</b>	WE320 000 273
<b>COMPANY NAME</b>	North Invent Norway	<b>NORTH INVENT TYPE NO</b>	WE320-01.MON.01-0273
<b>VAT</b>	987884002VAT	<b>DRAWING REFERENCE</b>	WE320 000 141 DRW
<b>ADDRESS</b>	Sørhauggata 128		
	5527 Haugesund		
	NORWAY		

## REVISION HISTORY

APPROVED	CHECKED	DRAWN	STATUS	DESCRIPTION
2021.11.01 OKJ	2021.11.01 OKJ	2021.11.01 ØKJ	Issued for Review	General Update

2018022201

1/5

Specifications subject to changes without prior notice. The contents of this page are property of North Invent Norway AS. All rights herein are reserved to North Invent Norway AS. This document cannot be reproduced without the written permission of the company.

**NORTH INVENT**  
Sørhauggata 128,  
NO-5527 Haugesund, Norway  
Phone: +47 48 84 02 00



# WAVE II 32" MONITOR

The Wave II Monitors are a series of well-designed, rugged LED displays with full glass front and PCAP multitouch option.

The minimized outer measurements and modular design offer unprecedented configuration and mounting flexibility. Our unique hinge design ensures that table-top or ceiling mounting is equally easy and visually appealing as flush mounting the glass front into a cut-out.

All our monitors are provided with either AC, DC or AC/DC Multipower, whereas our proprietary controllerboard offer extended functionality and connectivity options.

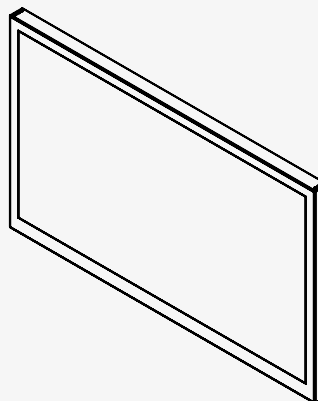

## TECHNICAL SPECIFICATIONS

WE320 000 273

### MATCHING STANDARDS

IEC 60945, IEC 61174 (ECDIS), IEC 60936 (Radar), IEC 62.288 (Navigation), IEC 62.388 (Radar), IEC 60529 (IP), IACS E10, EMC Directive-2014/30/EU, RoHS, REACH

DISPLAY SIZE	32.0" - 812.8 mm, Active area 698.40 (W) X 392.85 (H) mm
OVERALL DIMENSIONS	743.4 (W) x 447.9 (H) x 78 (D) mm
NET / GROSS WEIGHT	13 / 16.1 kg
RESOLUTION	Max 1920 x 1080 pixels (Full HD)
RESPONSE TIME	10 ms
CONTRAST RATIO	3000:1 (typ)
DOT PITCH	0.3637 (H) x 0.3637 (V) mm
LIGHT INTENSITY	500 cd/m <sup>2</sup> (typ)
NUMBERS OF COLOURS	16.7 Millions depending on graphics card
VIEWING ANGLE	±89°
CONTROL KNOBS	NO (Controllable by standard mouse interface)
SUPPLY VOLTAGE	90-264 VAC (IEC Inlet)
POWER CONSUMPTION	Approx. 41W
COLOUR	RAL 9005 Fine Structure
ENCLOSURE PROTECTION	IP 42 (From Front)
GLASS TYPE	4mm Tempered, Anti Reflective Conturan®
INPUT/ CONTROL INPUT	1 x DVI-I, 1 x Display port, DDC/CI (DVI & DP), RS 422/485, 2 x USB 2.0, Micro SD, USB Type B (Touch Only), 1 x Ethernet, HMI (15p D-Sub Female), RS 232 (9p D-Sub Female).
OPERATING / STORAGE TEMPERATURE	-15/+70° C, -15/+70° C (+5/+158° F, +5/+158° F)
BACKLIGHT LIFE	Typ 50,000 Hours
DIMMING RANGE	5-100%
INCLUDED ACCESSORIES	NO
TOUCH	10-point PCAP Multitouch
ADDITIONAL FEATURE	Onboard iMX6 CPU

2018101001

2/5

Specifications subject to changes without prior notice. The contents of this page are property of North Invent Norway AS. All rights herein are reserved to North Invent Norway AS. This document cannot be reproduced without the written permission of the company.

**NORTH INVENT**  
Sørhauggata 128,  
NO-5527 Haugesund, Norway  
Phone: +47 48 84 02 00



# WAVE II 32" MONITOR

## TECHNICAL SPECIFICATIONS

WE320 000 273

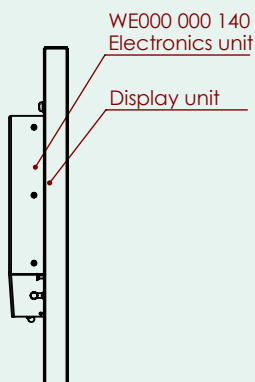
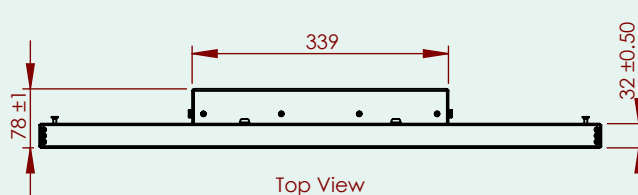
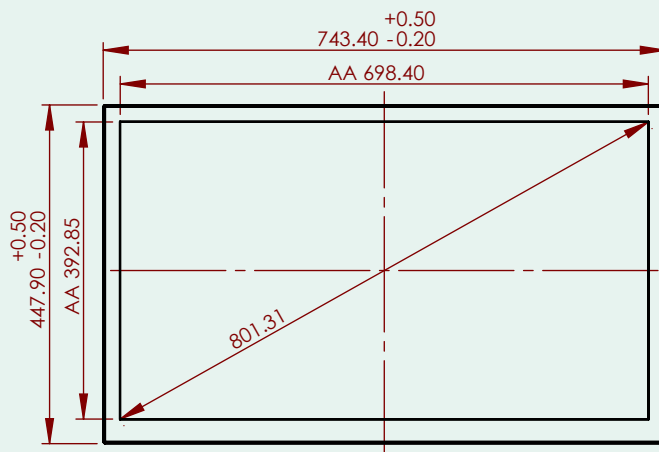

# WAVE II 32" MONITOR

## TECHNICAL SPECIFICATIONS

WE320 000 273

Bottom View



Back View

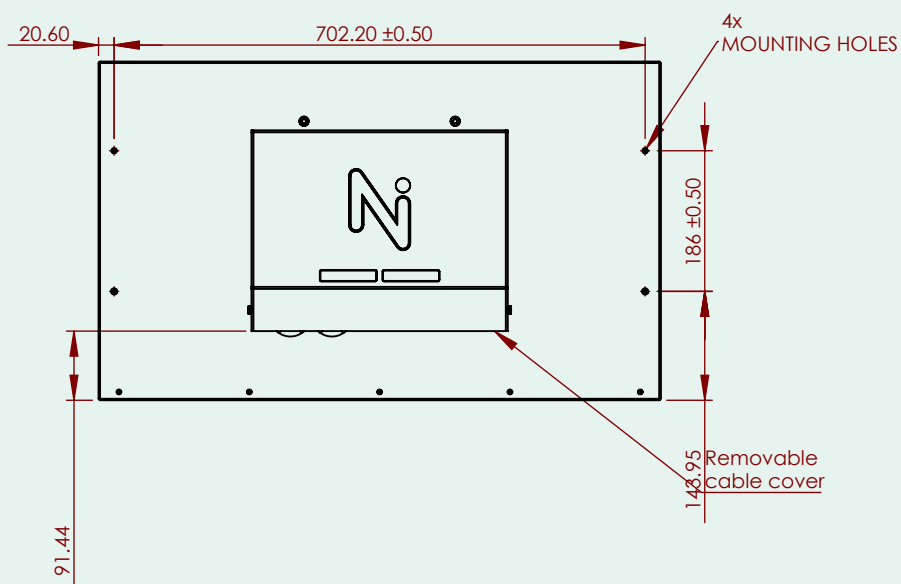

# WAVE II 32" MONITOR

## TECHNICAL SPECIFICATIONS

Included in Part 1 of 1

ITEM NO.	PART NUMBER	DESCRIPTION	QTY.
1	WE999 000 126	1.8m, AC Power Cable	1
2	WE999 000 128	1.8m, Display Port Cable	1

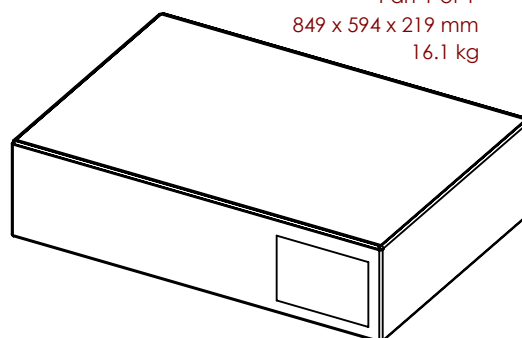
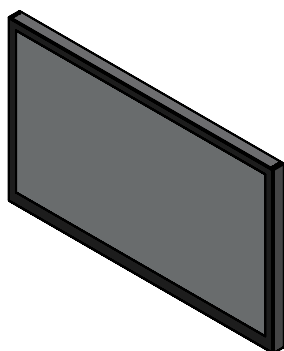

Part 1 of 1  
849 x 594 x 219 mm  
16.1 kg